

A-A

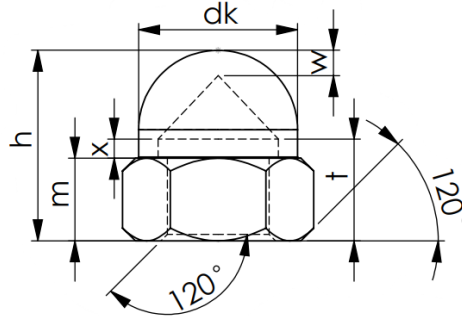

LEGENDS

- s : Width across flats
- e : Width across corners
- m : Height of the Nut Part
- d : Nominal Diameter fo thread
- h : Total Height of the Nut
- dk : Head Diameter

	Series 1	M4	M5	M6	M8	M10	M12	M14	M16	M18	M20	M22	M24
thread	Series 2	-	-	-	M8x1	M10x1	M12x1.5	M14x1.5	M16x1.5	M18x1.5	M20x2	M22x1.5	M24x2
	Series 3	-	-	-	-	M10 x1.25	M12 x1.25	-	-	M18x2	M20x1.5	M22x2	-
	P	Series 1	0.7	0.8	1	1.25	1.5	1.75	2	2	2.5	2.5	2.5
da	min.	4	5	6	8	10	12	14	16	18	20	22	24
	max.	4.6	5.75	6.75	8.75	10.8	13	15.1	17.3	19.5	21.6	23.7	25.9
dk	max.	6.5	7.5	9.5	12.5	15	17	20	23	26	28	33	34
dw	min.	5.9	6.9	8.9	11.6	14.6	16.6	19.6	22.5	24.9	27.7	31.4	33.3
e min.	Product grade A	7.66	8.79	11.05	14.38	17.77	20.03	23.35	26.75	30.14	33.53	37.72	39.98
	Product grade B	7.5	8.63	10.89	14.2	17.59	19.85	22.78	26.17	29.56	32.95	37.29	39.55
x max.	Series 1	1.4	1.6	2	2.5	3	-	-	-	-	-	-	-
	Series 2	-	-	-	2	2	-	-	-	-	-	-	-
	Series 3	-	-	-	-	2.5	-	-	-	-	-	-	-
g2 max.	Series 1	-	-	-	-	-	6.4	7.3	7.3	9.3	9.3	9.3	10.7
	Series 2	-	-	-	-	-	5.6	5.6	5.6	5.6	7.3	5.6	7.3
	Series 3	-	-	-	-	-	4.9	-	-	7.3	5.6	7.3	-
h	max. nominal size	8	10	12	15	18	22	25	28	32	34	39	42
	min. P. grade A	7.64	9.64	11.57	14.57	17.57	21.48	24.48	27.48	32.38	33.38	38.38	41.38
	min. P. grade B	7.42	9.42	11.3	14.3	17.3	21.16	24.16	27.16	31	33	38	41

thread	Series 1	M4	M5	M6	M8	M10	M12	M14	M16	M18	M20	M22	M24
	Series 2	-	-	-	M8x1	M10x1	M12x1.5	M14x1.5	M16x1.5	M18x1.5	M20x2	M22x1.5	M24x2
	Series 3	-	-	-	-	M10 x1.25	M12 x1.25	-	-	M18x2	M20x1.5	M22x2	-
m	max.	3.2	4	5	6.5	8.8	10	11	13	15	16	18	19
	min.	2.9	3.7	4.7	6.14	7.64	9.64	10.3	12.3	14.3	14.9	16.9	17.7
Mw	min.	2.32	2.96	3.76	4.91	6.11	7.71	8.24	9.84	11.44	11.92	13.52	14.16
r	approx.	3.25	3.75	4.75	6.25	7.5	8.5	10	11.5	13	14	16.5	17
s	Max. = nominal size	7	8	10	13	16	18	21	24	27	30	34	36
	min. P. grade A	6.78	7.78	9.78	12.73	15.73	17.73	20.67	23.67	26.67	29.67	33.38	35.38
	min. P. grade B	6.64	7.64	9.64	12.57	15.57	17.57	20.16	23.16	26.16	29.16	33	35
t	min.	5.26	7.21	7.71	10.65	12.65	15.65	17.65	20.58	24.58	25.58	28.58	30.5
	max.	5.74	7.79	8.29	11.35	13.35	16.35	18.35	21.42	25.42	26.42	29.42	31.5
w	min.	2	2	2	2	2	3	4	4	5	5	5	6
Weight kg/1000pcs		-	-	4.66	11	20.1	28.3	-	54.3	95	104	-	216